

PRODUCT SPECIFICATIONS

Stile:	1 1/16" x 2" Beaded
Top & Bottom Rail:	7/8" thick, cut from 5" stock
Divider Rail:	7/8" thick; 2", 3" & 4"* wide *Recommended on panels over 75" high
Louvers:	(3/8" thick); 2 1/2", 3 1/2" & 4 1/2"
Material:	Basswood and Poplar.
Construction:	3" Dowels on 1 1/2" Centers
Tension System:	Adjustable tension screws
Tilt Rod:	1/2" thick, 5/8" wide
Hinge Mortise:	As specified

RECOMMENDED PANEL WIDTH

	MINIMUM	MAXIMUM
2 1/2" LOUVERS	12	28"
3 1/2" LOUVERS	12	32"
4 1/2" LOUVERS	12	36"

FRAME PROFILES

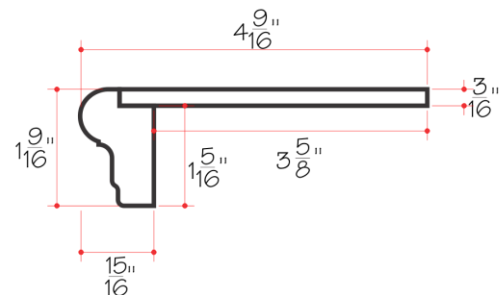
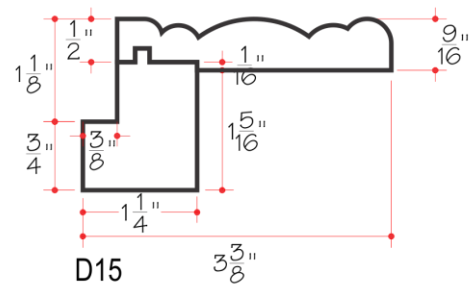
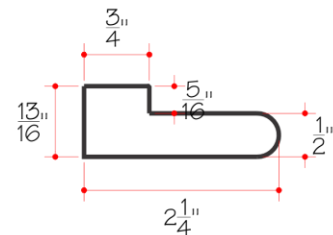
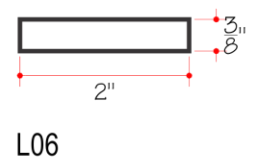
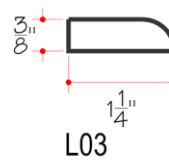
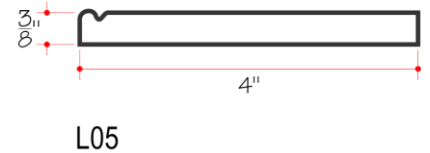
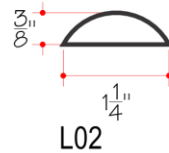
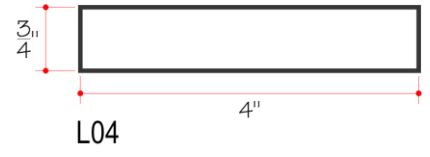
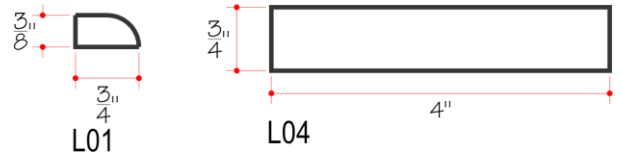

SILL CAP